

KEKALBOLEH SDN BHD  
 (199901021248/496148-K)  
 Lot No. 7, Lorong Perindustrian Kolombong Jaya,  
 Pusat Perindustrian Kolombong Jaya,  
 Mile 5.5, Jalan Kolombong,  
 88450 Kota Kinabalu, Sabah.  
 Tel/WhatsApp: 088-385555 / 013-8867570  
 Website: kekalboleh.com



FLEXIBLE

# UNIVERSAL COUPLING & FLANGE ADAPTOR

## WIDE-TOLERANCE SOLUTIONS FOR RIGID MATERIAL PIPES



Universal Coupling



Universal Flange Adaptor

	Universal Coupling	Universal Flange Adaptor
<b>In Brief</b>	<ul style="list-style-type: none"> <li>▶ For Connecting All Kinds of Rigid Material Pipes (Asbestos Cement (AC), Mild Steel (MS), Ductile Iron (DI), Cast Iron (CI), UPVC, PVC-M, PVC-O, ABS &amp; etc.)</li> <li>▶ Working Pressure PN10/PN16</li> <li>▶ Suitable for Potable Water, Neutral Liquids and Sewage</li> <li>▶ Coating : Fusion Bonded Epoxy</li> <li>▶ Seal : EPDM</li> </ul>	
<b>Standards</b>	▶ Test : BS EN 12266-1	▶ Flange : BS EN 12266-1
<b>Features</b>	<ul style="list-style-type: none"> <li>▶ Range of Joint Sizes : DN80 to DN600</li> <li>▶ Wide OD Tolerance Range</li> <li>▶ Angular Deflection of Max. <math>\pm 6^\circ</math></li> <li>▶ For Quick &amp; Emergency Pipe Repairing &amp; Maintenance</li> <li>▶ Gasket with Circumferential Ribs Makes Sealing on Different Types of Water Pipe Leak Possible (Scored, Corroded, Pitted Pipes &amp; etc.)</li> <li>▶ Installation Time Saving Pre-assembled without the Need for Pipe Preparation</li> </ul>	



**LYE MANUFACTURING SDN.BHD.** (197701001852 (32836-H))  
 Manufacturer of Valves, Hydrants, Joints, Fittings & Manhole Covers

# UNIVERSAL COUPLING & FLANGE ADAPTOR

## WIDE-TOLERANCE SOLUTIONS FOR RIGID MATERIAL PIPES

### Technical Table

## Universal Coupling

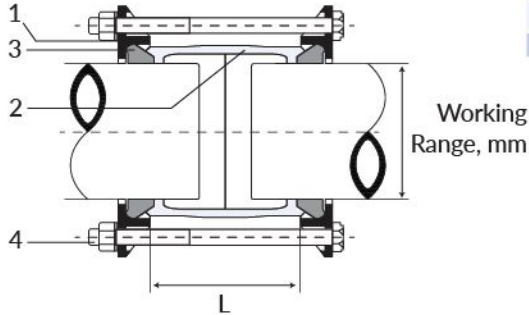

### Assembly Chart

No.	DN (mm)	Component	Material	Standard Ref.
1	80-600	Gland Flange	Ductile Iron	BS EN 1563
2	80-300	Body	Ductile Iron	BS EN 1563
	400-600		Carbon Steel	EN 10025
3	80-600	Gasket	EPDM	BS EN 681
4	80-600	Bolt & Nut	Hot Dipped Galvanized	BS EN 4190

### Specifications & Parameters Chart

DN (mm)	Working Range (mm)		L (mm)	Bolts
80	88	103	100	M12x4
100	108	128	100	M12x4
150	159	182	100	M12x4
200	218	235	100	M12x4
250	271	289	100	M12x6
300	322	350	100	M12x6
400	400	429	150	M16x8
500	500	532	150	M16x10
600	600	635	150	M16x10

## Universal Flange Adaptor

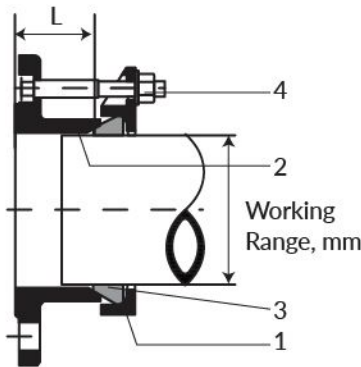

### Assembly Chart

No.	Component	Material	Standard Ref.
1	Gland Flange	Ductile Iron	BS EN 1563
2	Body	Ductile Iron	BS EN 1563
3	Gasket	EPDM	BS EN 681
4	Bolt & Nut	Hot Dipped Galvanized	BS EN 4190

### Specifications & Parameters Chart

DN (mm)	Working Range (mm)		L (mm)	Bolts	Flange Standard
80	88	103	75	M12x4	PN10+PN16+BS10/E+ANSI/150
100	108	128	75	M12x4	PN10+PN16+BS10/E+ANSI/150
150	159	182	75	M12x4	PN10+PN16+BS10/E+ANSI/150
200	218	235	75	M12x4	PN10+PN16+BS10/E+ANSI/150
250	271	289	100	M12x6	PN10+PN16+BS10/E+ANSI/150
300	322	350	100	M12x6	PN10+PN16+BS10/E+ANSI/150
400	400	429	120	M16x8	PN10+PN16
500	500	532	123	M16x10	PN10+PN16
600	600	635	135	M16x10	PN10+PN16

Note: Technical data provided in this brochure is indicative only and may be subject to change without prior notice.